



TimeLapse

HD Video Camera

TLC 200

User Manual

www.brinno.com

Length of battery usage

Time Interval	Capture Frames	Battery Life
1 Second	310000	3.6 Days
5 Seconds	300000	17.4 Days
10 Seconds	260000	30.1 Days
20 Seconds	210000	48.6 Days
30 Seconds	180000	62.5 Days
1 Minute	120000	83.3 Days
5 Minutes	35000	121.5 Days
10 Minutes	18000	125 Days
1 Hour	3200	133.3 Days
4 Hours	850	141.7 Days
24 Hours	137	137 Days

Thank you for purchasing Brinno TimeLapse Camera!

Brinno **TimeLapse Camera (TLC 200)** using unique **Time Lapse** and **Power Saving** technology to capture frames for long time using, you can use it to record your Daily Life, Projects, anything you want to record. Brinno TimeLapse Camera TLC200 is an easy solution for creating Time Lapse videos. Turn it on, set time interval, frame to subject, waiting for finished, get the time lapse video! No fancy equipment, no intervalometer, no complicated gear setups, no time-controlling, no video-making troubles.

TimeLapse Camera TLC200 Features



Time Lapse Video

TLC200 provides you a 1280x720 resolution video, yes, it's HD video.

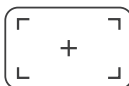

LCD Viewfinder

Through 1.44" LCD screen, you can frame to your subject easily.



Rotatable Lens

Rotatable lens allows you to find your subject easily!

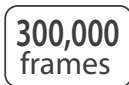

Power Saving

TLC200 comes with unique Power control technology, 4 AA batteries can capture 300,000 frames.



Simple Solution

Just turn it on and shoot, we will give you a time lapse video!



Extension Lens*

Unique design allows you to attach optional extension lens.

**Optional accessories.*

TLC200 Output file format

- Video Mode:

Format: AVI.

Resolution: 1280x 720, 640x 480

Note: The maximum size of each single AVI file is in a range between 8,192 to 20,480 frames, it depends on time interval setting.

- Still Image Mode (**only for using Shutter Line**):

Format: JPEG.

Resolution: 1280x 720, 640x 480

Package Contents

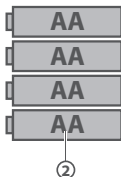
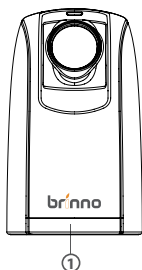

1 TimeLapseCam (TLC200)

2 4 AA Batteries

3 SD card*

*SD Card included or not, depends on the description on package box.

Parts of the Camera

Front



Back



1 SD Card Cover

2 Connector for Accessories

(For Shutter Line, PIR sensor using)

3 Connector for Micro USB cable
*(Only for extension power supplier,
DC 5V)*

4 Lens

5 Battery Door

6 Strap Eyelet

7 LCD Screen

8 MENU (◀) Button

9 TIME (▶) Button

10 OK/ START Button

11 Power Switch

12 LED Indicator

13 Tripod Screw Hole

Display Icons

Setting screen

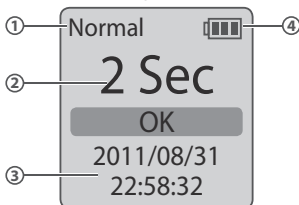



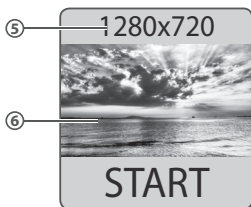

Preview screen



At Setting screen

- 1 Capture mode
Normal: Time Lapse mode
Shutter: Shutter Line mode
Motion: Motion Activated mode
- 2 Time interval
Select the pre-set time interval or custom by yourself.
- 3 System date and time
- 4 Battery level

Icon	Description
 (green)	Battery fully charged.
 (green)	Battery partially discharged.
 (yellow)	Low battery. Replace as soon as possible.
 (red)	Out of battery. Replace battery immediately.

At Preview screen

- 5 Video/ Image resolution
- 6 Preview image

Status icon

- 7 Battery Empty
Please replace battery immediately.
- 8 SD Card Full
Please clear up SD card space.
- 9 SD Card Error
Please replace SD card.
- 10 No Card
Please Insert SD card.

About Power Saving

Setting screen

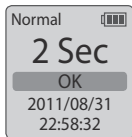

10 sec.

Preview screen



30 sec.

Turn off LCD



1 At Setting Screen

After **10** seconds without activity at setting screen, camera will go to Preview screen automatically. You can press **MENU** or **TIME** button to back to setting screen.

2 At Preview Screen

After **30** seconds without activity at preview screen, LCD screen will turn off automatically to save power. You can press **OK** button to wake up camera.

Initial Step-1 *Install Batteries and SD Card*

1



2

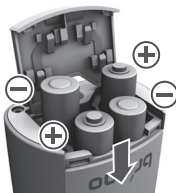

3

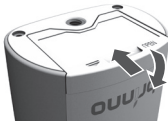

1 Open battery door.

2 Insert 4 AA batteries.

3 Close battery door.

 **Be sure the battery cover is locked into place.**

Initial Step-2

Install SD Card

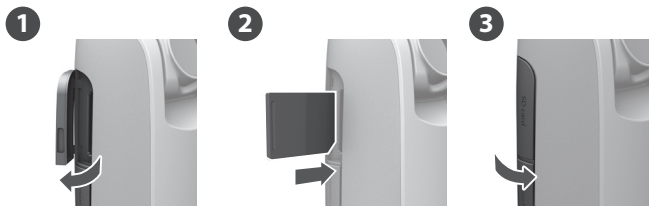

- 1 Open SD card cover.
- 2 Insert SD card until it clicks into place.
- 3 Close SD card cover.

Initial Step-3

Turning the Camera on

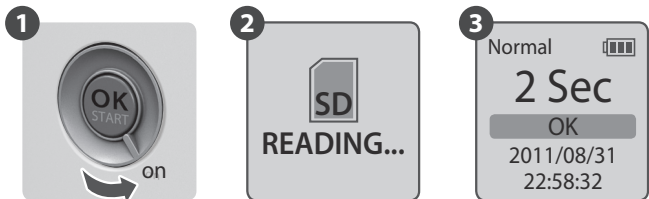



- 1 Rotate the **Power** switch to **ON** position.
- 2 Process screen
⚠ It may display other information on screen, please refer to page 3.
- 3 Setting screen

Now, you can Set Date and Time and Time Interval before your first time to use TimeLapse Camera!

Initial Step-4

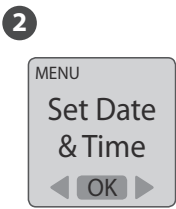
Set Date and Time

- 
 - 
 - 
- 1 Press **MENU** button.
- 2 Press **TIME** (▶) to select **Set Date & Time**, then press **OK** button.
- 3 At the highlight field, press **MENU** (◀) to decrease value, press **TIME** (▶) to increase value, press **OK** to confirm and go to next field, when finished press **OK** to exit setting.

Initial Step-5

Set Time Interval

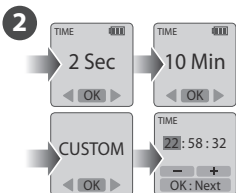
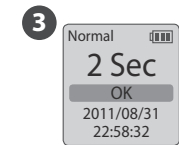
- 
- 
- 

- 1 Press **TIME** button to time interval setting.
- 2 Press **MENU** (◀) and **TIME** (▶) to select pre-set time interval or custom it by yourself, finally press **OK** to confirm and back to setting screen.
- 3 At setting screen
- Now, you are ready to go to Preview screen and start record your Time Lapse Video.**

Start Recording



- 1 Turn on TLC200, set time interval and press OK to **Preview Screen**.
- 2 Adjust lens angle to frame subject.
- 3 At Preview screen, press OK button to start recording, during recording period LCD panel will turn off to save power.

Stop Recording

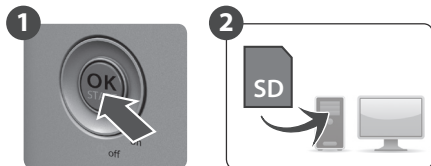

- 1 During recording period, hold **OK** button till LCD screen lights on, it means finish recording.
- 2 Remove SD card from camera, and plug into your computer or notebook to enjoy the amazing **Time Lapse Video!**

LED Indicator



Green LED light: Capturing image.

During recording process, the Green LED will flash once when it is capturing image, the flashing frequency depends on time interval setting.

Red LED light: Low battery level, Low SD card level.

Output Resolution

You can change video resolution at this setting.



1 Select **Output Resolution**.

2 There are two options you can select: **1280x720**, **640x480**.

Set Date and Time

Set correct date and time for your camera.

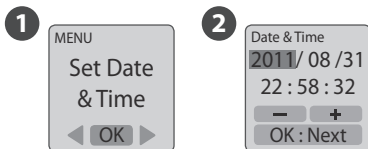

1 Select **Set Date & Time**.

2 At the highlight field, press **MENU** (—) to decrease value, press **TIME** (+) to increase value, press **OK** to confirm and go to next field, when finished press OK to exit setting.

AVI Frame Rate

You can change video FPS (**frames per second**) at this setting.

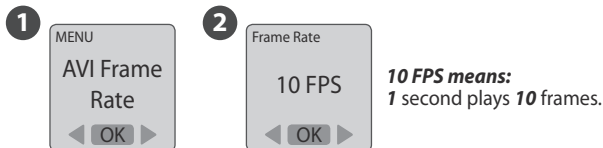

1 Select **AVI Frame Rate**.

2 What frame rate should I use?

Generally, **10 FPS** is better for Time Lapse video.

1 FPS: the video 1 second plays 1 frame , so the video will look not smooth, and video length will longer.

30 FPS: the video 1 second plays 30 frame , so the video will look smooth, but video length will shorter.

Low Light Recording

You can choose if enable your camera keep recording video in a low light environment(< 5 Lux) or not.



1 Select **Low Light Recording**.

2 ON: Allows your camera to record video in a low light environment .

OFF: Your camera will go into **Sleep Mode** in a low light environment.

Time Stamp

You can choose if you want to show time stamp at bottom of video.

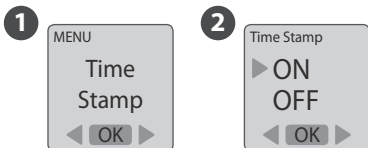

1 Select **Time Stamp**.

2 Select ON or OFF.

LED Display

You can choose if the LED indicator will flash while capturing frame.

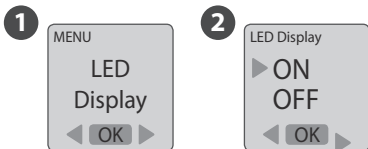

1 Select **LED Display**.

2 ON: When camera is capturing frame, the LED indicator will flash once.
OFF: During capture period LED indicator will not flash .

Band Filter

Select the correct lighting frequency to match your indoor lighting frequency.

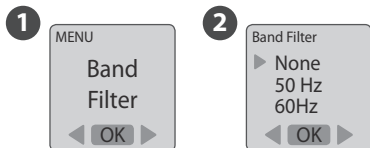

1 Select **Band Filter**.

2 **None:** For outdoor environment.

50 Hz: USA

60 Hz: Europe

Firmware Version

Display the current firmware version of camera.

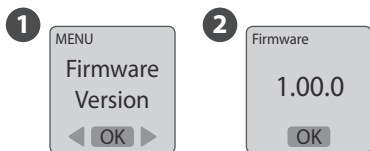

1 Select **Firmware Version**.

2 Show the firmware version till 30 seconds, also you can press OK button to exit.

Reset

You can reset your camera back to default setting.

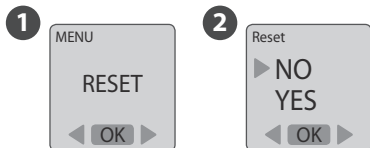

- Select **Reset**.
- Select **YES** and press OK button to reset your camera.

Default setting:

Function	Setting
Time Interval	2 Seconds
Output Resolution	1280x720
AVI Frame Rate	10 FPS
Low Light Recording	ON
Time Stamp	ON
LED Display	ON
Band Filter	None

Specifications

Model	TLC 200
Output format	- Video Mode Format: AVI. Resolution: 1280x720, 640x480 - Still Image Mode (only for using Shutter Line) Format: JPEG. Resolution: 1280x720, 640x480
Field of View	59°
Focal Length	36 mm (35mm equivalent)
Focus Distance	75 cm (Minimum)
Time Interval	from 1 sec to 24 hours
Memory Storage	SD Card (Supported Up to 32GB)
LCD Screen	1.44" TFT LCD
Power Supply	DC IN: 5V (Micro USB connector) Battery: 4 AA Batteries
Size (DxWxH)	64x 46x 106 mm
Weight	120 g(without batteries)

Package Contents

TimeLapse Camera (TLC200)	1	User Manual	1
AA Battery	4		
2GB SD card*	1		

* SD Card included or not, depends on the description on package box.

Thank you for purchasing Brinno TimeLapse Camera!

If you have any questions or problems setting up your Brinno TimeLapse Camera please contact the sales staff where you purchased our product or email us at Brinno Incorporated directly **customerservice@brinno.com**

Please Visit our website
www.brinno.com

